

EA200 Plus

600 VA ~ 800 VA



Features

- Microprocessor-based digital control
- Boost and buck AVR for voltage stabilization
- Auto sensing frequency
- Wide input voltage range
- Power-on self test
- Cold start
- Auto restart when mains power is restored
- Auto track mains phase to ensure that inverter output voltage has same phase with utility voltage, reducing transfer time and peak surge
- Intelligent battery management: battery temperature compensation to extend the battery life; three-stage charging to shorten recharge time
- Short circuit, battery overcharge / overdischarge, overload, surge protections
- Automatic charging in OFF mode
- 2 USB charger with 5 V / 1 A output (6 Schuko outlets model only)
- Optional RS232 / USB communication port and RJ11 port

Control Panel

1. AC Normal Indicator (green)
2. Battery Charging Indicator (amber)
3. Back-up Indicator (red)
4. On / Off button
5. USB charger (optional)

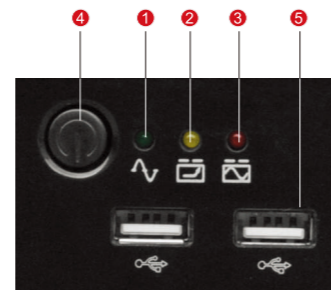

Rear Panel

1. UPS output with surge protection
2. Bypass output with surge protection
3. AC Input
4. USB (optional)
5. RS232 (optional)
6. RJ11 (optional)



Specifications

MODEL	EA260P	EA280P
Capacity	600 VA / 360 W	800 VA / 480 W
INPUT		
Voltage	100 / 110 / 120 V: 80 ~ 150 Vac; 220 / 230 / 240 V: 162 ~ 295 Vac (145 ~ 295 Vac optional)	
Frequency	50 / 60 Hz ± 10% (auto-sensing)	
OUTPUT		
Voltage	100 / 110 / 120 Vac ± 10% or 220 / 230 / 240 Vac ± 10%	
Frequency	50 / 60 Hz ± 1% (auto-sensing)	
Waveform	Mains mode: pure sine wave; Battery mode: simulated sine wave	
Transfer time	Typical 2 ~ 7 ms, 10 ms Max.	
BATTERIES		
DC voltage	12 V	
Configuration	12 V / 7.0 Ah x 1	12 V / 8.0 Ah x 1
Recharge time	6 ~ 8 h	
COMMUNICATIONS		
USB / RS232 / SNMP (optional)	Supports Windows® 98 / 2000 / 2003 / XP / Vista / 2008 / 7 / 8 / 10	
OTHERS		
Protections	Short circuit – battery overcharge – overdischarge – overload – surge	
Humidity	20 ~ 90% RH @ 0 ~ 40°C (non-condensing)	
Noise level	≤ 45 dB (1 m)	
Net / Gross weight (kg)	4.5 / 5.0	5.6 / 6.0
Dimensions (W × D × H) (mm)	185 × 280 × 95	
Packaged dimensions (W × D × H) (mm)	145 × 333 × 238	
Quantity / 20 ft	2400 pcs	

- All specifications are subject to change without notice.
- Custom-made specifications are acceptable.